

1245

With flange, high-force brass guide bush, CNOMO
带法兰，高力黄铜导套，CNOMO

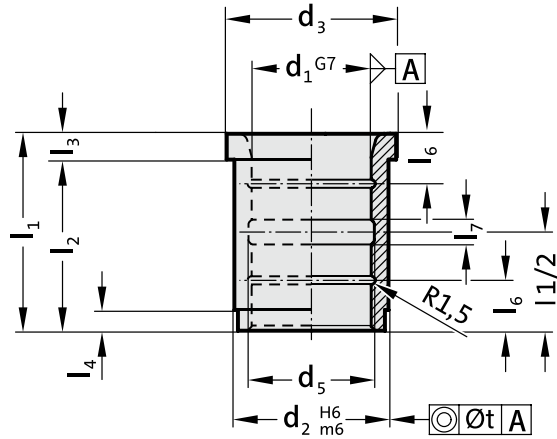

1245.



Material 材料:

CuZn25Al5Fe3Mn3

Note 注意:

The guide bush can only be used in axial movement.

The inner diameter contracts when pressed.

该导套只能在轴向运动上使用。

压入时内径收缩。



1245. With flange, high-force brass guide bush, CNOMO

1245. 带法兰，高力黄铜导套，CNOMO

d1	20	25	32	40	50	63	80	100
d2	28	35	44	52	63	80	100	125
d3	32	40	50	60	71	90	112	140
d5	22	27	34	42	52	65	82	102
l1	32	40	50	63	80	100	125	160
l2	28	35	44	55	70	88	109	140
l3	4	5	6	8	10	12	16	20
l4	3	5	8	8	8	10	10	10
l6	-	-	12	16	20	25	32	40
l7	5	5	5	8	10	12	16	20
t	0.01	0.01	0.01	0.02	0.02	0.02	0.02	0.20



Order 订购

Catalog No. 目录号

1245

d₁

020

l₁

032